

A3 Colour Intelligent Devices

IM C3000(A)

IM C3500(A)

✔ Printer ✔ Copier ✔ Scanner ✔ Fax



Welcome to a new era of technology that keeps your workplace up-to-date, now and in the future. Smarter working made simple thanks to the IM C3000(A)/C3500(A).

Now is the time to:

- Protect your devices with easy access to security updates
- Take advantage of easy productivity upgrades at your own pace
- Save costs by bringing high-standard quality print output in-house
- Maximise productivity with streamlined workflows

Today's workplace needs to be ready for tomorrow. Ricoh's intelligent devices provide smooth access to functionality upgrades and productivity enhancements when they are released, without needing to change your hardware. Turn your device into a powerful hub that helps you manage information workflows efficiently, using technology that's scalable, secure, sustainable and simple.

Get greater control of scan and print management:

- Scan smaller documents with the small size paper scan unit
- Improve scan accuracy – double feed detection unit
- Enhance print management – with EFI controller
- Produce professional grade flyers with inner multi-folding unit

Embrace lower running costs and reduced energy consumption thanks to environmentally friendly low TEC (Typical Electricity Consumption) values. Furthermore, take advantage of RICOH Intelligent Support services that anticipate potential issues and send corrective instructions via the Smart Operation Panel, avoiding interruptions and prolonging the optimal performance of your device – avoiding the need for intervention by more costly IT resources.

Printing from 30 to 35 CPM, the IM C3000(A)/C3500(A) offer next-level productivity. Interact with the 10.1” Smart Operation Panel like a typical smart device and configure it for quick and easy access to apps you use most often. A variety of mobile connectivity options enable printing or scanning to the office network or cloud from a smart device, with built-in support for NFC, AirPrint* or Mopria. All this underpinned by a unique suite of support apps from RICOH Smart Integration.

Our intelligent devices offer:

- Efficient working and reduced user intervention – by expanding paper capacity
- Variable finishing and paper options – for a professional touch
- A consistent user experience across your fleet
- Maximum device uptime and minimal disruption with RICOH Intelligent Support

IM C3000(A) / IM C3500(A) hardware configuration

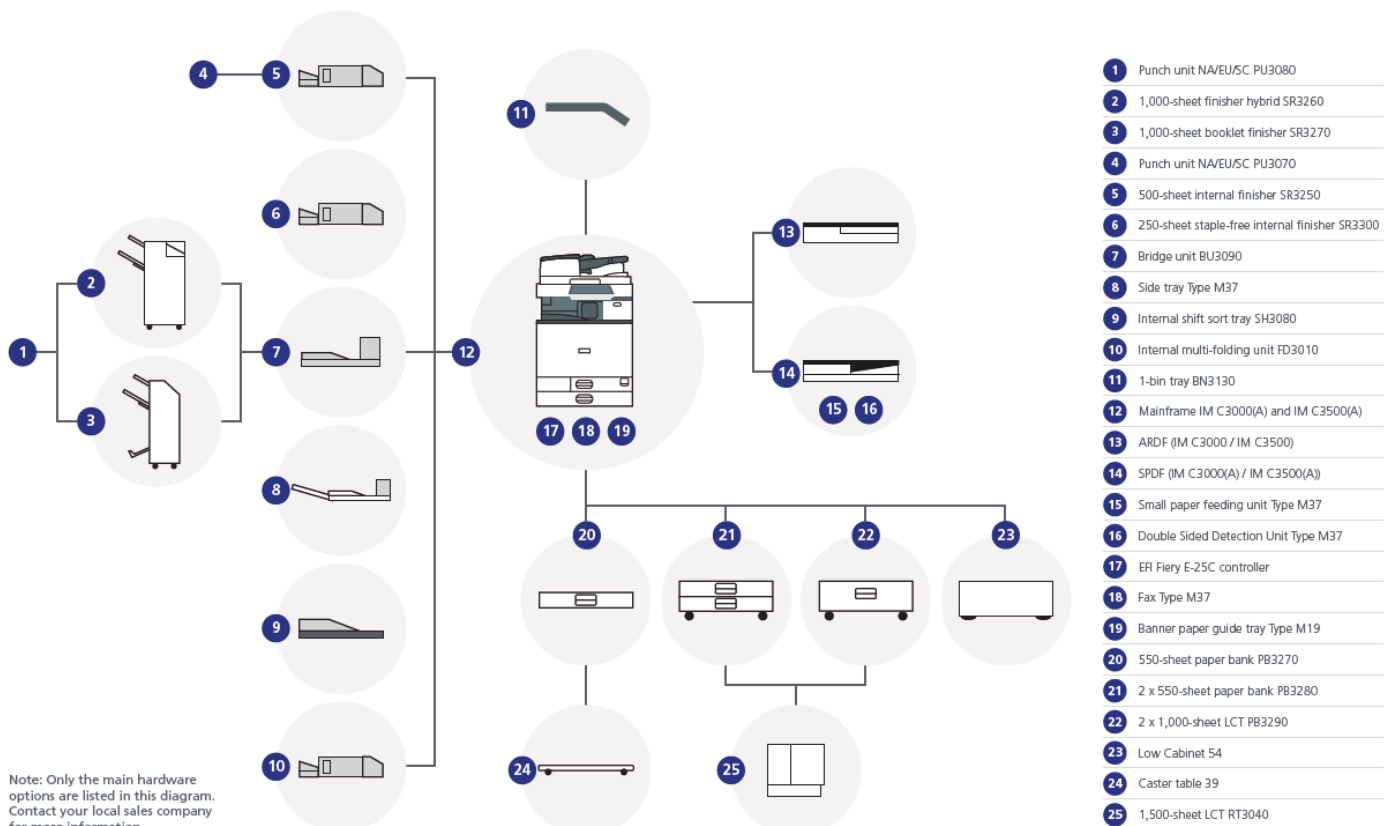

IM C3000A/IM C3000/IM C3500A/IM C3500

MAIN SPECIFICATIONS

| | IM C3000 | IM C3000A | IM C3500 | IM C3500A |
|--|--|--------------------|-----------------------|--------------------|
| GENERAL | | | | |
| Warm-up time | | | 21 seconds | |
| First output speed: B/W | | | 4.5 seconds | |
| First output speed: full colour | | | 6.9 seconds | |
| Continuous output speed | 30 ppm | 30 ppm | 35 ppm | 35 ppm |
| Memory: standard | | | 2 GB | |
| Memory: maximum | | | 4 GB | |
| HDD: standard | | | 320 GB | |
| HDD: maximum | | | 320 GB | |
| ARDF capacity | | | 100 sheets | |
| SPDF capacity | | | 220 sheets | |
| Weight | 99.4 kg | 94 kg | 99.4 kg | 94 kg |
| Dimensions: W x D x H | 587 x 685 x 963 mm | 587 x 685 x 913 mm | 587 x 685 x 963 mm | 587 x 685 x 913 mm |
| Power source | | | 220 - 240 V, 50/60 Hz | |
| COPIER | | | | |
| Multiple copying | Up to 999 copies | | | |
| Resolution | 600 dpi | | | |
| Zoom | From 25% to 400% in 1% steps | | | |
| PRINTER | | | | |
| CPU | ApolloLake E3930 1.3 GHz | | | |
| Printer language: standard | PCL5c, PCL6, PostScript 3 (emulation), PDF direct (emulation) | | | |
| Printer language: option | Genuine Adobe® PostScript® 3™, PictBridge, PDF Direct from Adobe® | | | |
| Print resolution: maximum | 1,200 x 1,200 dpi | | | |
| Network interface: standard | Ethernet 10 base-T/100 base-TX/1000 base-T, USB Host I/F Type A, USB Device I/F Type B | | | |
| Network interface: option | Bi-directional IEEE 1284/ECP, Wireless LAN (IEEE 802.11a/b/g/n), Additional NIC (2nd port) | | | |
| Mobile printing capability | Apple AirPrint™, Mopria, Google Cloud Print, NFC, Ricoh Smart Device Connector | | | |
| Windows® environments | Windows® 7, Windows® 8.1, Windows® 10, Windows® Server 2008, Windows® Server 2008R2, Windows® Server 2012R2, Windows® Server 2016 | | | |
| Mac OS environments | Macintosh OS X Native v10.11 or later | | | |
| UNIX environments | UNIX Sun® Solaris, HP-UX, SCO OpenServer, RedHat® Linux Enterprise, IBM® AIX | | | |
| SAP® environments | SAP® R/3®, SAP® S/4® | | | |
| Other supported environments | IBM iSeries | | | |
| SCANNER | | | | |
| Scanning speed: ARDF | 80 ipm (200/300 dpi) | | | |
| Scanning speed: SPDF | 120 ipm (simplex)/240 ipm (duplex) | | | |
| Resolution: maximum | 1,200 dpi | | | |
| Compression method | TIFF (MH, MR, MMR, JBIG2), Grayscale | | | |
| File formats | Single Page TIFF, Single page JPEG, Single page High compression PDF, Single page PDF/A, Multi page TIFF, Multi page PDF, Multi page High compression PDF, Multi page PDF/A | | | |
| Scan modes | E-mail, Folder, USB, SD Card | | | |
| FAX (OPTION) | | | | |
| Circuit | PSTN, PBX | | | |
| Transmission speed | 2 seconds | | | |
| Modem speed: maximum | 33.6 Kbps | | | |
| Resolution: standard | 8x3.85 line/mm, 200x100 dpi | | | |
| Resolution: option | 16x15.4 line/mm, 400x400 dpi | | | |
| Compression method | MH, MR, MMR, JBIG | | | |
| Scanning speed | 81 spm | 68 spm | 81 spm | 68 spm |
| Memory: standard | 4 MB, (320 pages) | | | |
| Memory: maximum | 60 MB, (4,800 pages) | | | |
| PAPER HANDLING | | | | |
| Recommended paper size | Standard paper tray(s):SRA3, A3, A4, A5, A6, B4, B5, B6, Envelopes Optional paper tray(s):SRA3, A3, A4, A5, A6, B4, B5, B6, Envelopes Bypass tray:SRA3, A3, A4, A5, A6, B4, B5, B6, Envelopes, Custom Size paper | | | |
| Paper input: standard | 1,200 sheets | | | |
| Paper input: maximum | 4,700 sheets | | | |
| Paper output: standard | 500 sheets | | | |
| Paper output: maximum | 1,625 sheets | | | |
| Paper weight | Trays: (60 - 300 g/m²), Bypass: (52 - 300 g/m²), Duplex: (52 - 256 g/m²) | | | |
| Paper types | Plain paper, Recycle paper, Special paper, Color paper, Letterhead, Cardstock, Preprinted paper, Bond paper, Coated paper, Envelope, Gloss paper, Label paper, OHP | | | |
| ECOLOGY | | | | |
| Power consumption: max. | Less than 1,700 W | | | |
| Power consumption operation: B/W | 503.3 W | 503.3 W | 532.9 W | 532.9 W |
| Power consumption operation: Full colour | 559.7 W | 559.7 W | 598.6 W | 598.6 W |
| Power consumption: ready | 47.6 W | | | |
| Power consumption: sleep | 0.55 W | | | |
| TEC | 1.2 kWh | 1.2 kWh | 1.3 kWh | 1.3 kWh |

IM C3000A/IM C3000/IM C3500A/IM C3500

MAIN SPECIFICATIONS

| | IM C3000 | IM C3000A | IM C3500 | IM C3500A |
|--|---|-----------|----------|-----------|
| OUTPUT TRAYS AND FINISHER OPTIONS | | | | |
| 2x 550-sheet Paper tray | Paper size: (SRA3, A3, A4, A5, A6, B4, B5, B6), Paper weight: (60-300 g/m ²) | | | |
| 1x 550-sheet Paper tray | Paper size: (SRA3, A3, A4, A5, A6, B4, B5, B6), Paper weight: (60-300 g/m ²) | | | |
| 2,000-sheet Large capacity tray | Paper size: (A4), Paper weight: (60-300 g/m ²) | | | |
| 1,500-sheet side Large capacity tray | Paper size: (A4, B5), Paper weight: (60-300 g/m ²) | | | |
| 1,000-sheet Hybrid finisher | Paper size: (SRA3, A3, A4, A5, A6, B4, B5, B6), Paper weight: (52-300 g/m ²), 1,000 sheets, Staple capacity: (50 sheets), Staple paper size: (A3, A4, A5, B4, B5), Staple paper weight: (52-105 g/m ²), Staple positions: (Top, Bottom, 2 Staples) | | | |
| 1,000-sheet Booklet finisher | Paper size: (SRA3, A3, A4, A5, A6, B4, B5, B6), Paper weight: (52-300 g/m ²), Stack capacity: (1,000 sheets), Staple capacity: (50 sheets), Staple paper size: (A3, A4, A5, B4, B5), Staple paper weight: (52-105 g/m ²), Staple positions: (Top, Bottom, 2 staples, Booklet) | | | |
| 250-sheet Internal finisher | Paper size: (A3, A4, A5, A6, B4, B5), Paper weight: (52-300 g/m ²), Stack capacity: (250 sheets), Staple capacity: (5 sheets), Staple paper size: (A3, A4, A5, B4, B5), Staple paper weight: (64-80 g/m ²), Staple positions: (Top) | | | |
| 500-sheet Internal finisher | Paper size: (A3, A4, A5, A6, B4, B5), Paper weight: (52-300 g/m ²), Stack capacity: (500 sheets), Staple capacity: (50 sheets), Staple paper size: (A4, A5, B4, B5), Staple paper weight: (52-105 g/m ²), Staple positions: (Top, Bottom, 2 staples) | | | |
| Internal shift tray | Tray capacity: (250 sheets), Paper size: (SRA3, A3, A4, A5, A6, B4, B5, B6), Paper weight: (52-300 g/m ²) | | | |
| One-bin tray | Tray capacity: (125 sheets), Paper size: (A3, A4, A5, B3, B4), Paper weight: (52-300 g/m ²) | | | |

OTHER OPTIONS

Fax unit, G3 Interface, Fax connection unit, Fax memory unit, Cabinet, Caster table, VM card, Memory unit, Side Tray, Banner paper guide tray, Punch units, Internal Multi-fold unit, Camera direct print card, Genuine PostScript 3, IEEE 1284 I/F, IEEE 802.11 a/g/n I/F, Device server unit, File format converter, OCR unit, Enhanced security HDD, Data overwrite security unit, Small paper feeding unit, Page keeper, Imageable area extension unit, ADF handle, External keyboard bracket, Counter I/F unit, Key counter bracket, NFC card reader, Smart card reader built-in unit, EFI controller, EFI Impose, EFI Compose, EFI Hot folders, EFI Spot on

CONSUMABLES

| | |
|----------------------------|---------------|
| Toner: black | 31,000 prints |
| Toner: cyan/magenta/yellow | 19,000 prints |

Consumable yield figures are based on 2p/j 5% coverage on A4

*Airprint certification will be available in 2019.



RICOH @Remote

